

#### Product packaging logic diagram

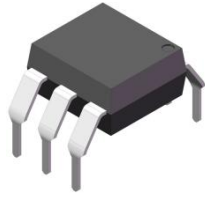

DIP6



DIP6-M

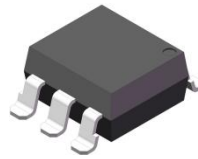

SMD6

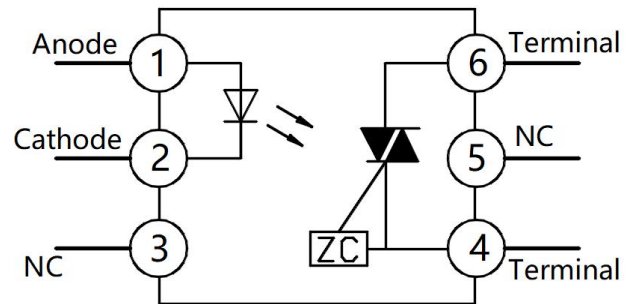

Pin Configuration

#### Features

- Peak breakdown voltage:  
250V: XL303X; 400V: XL304X;  
600V: XL306X; 800V: XL308X
- High isolation voltage between input and output (Viso = 5000Vrms)
- Operating Temperature: -55°C~100°C
- Environmentally friendly products, compliant with CQC, UL, and VDE requirements

#### Mechanical Data

- Case: DIP6, DIP6-M, SMD6
- Molding Compound: UL Flammability Classification Rating 94V-0
- Terminals: Matte tin-plated leads; solder ability-per MIL-STD-202, Method 208

#### Applications

- Industrial Automation and Control.
- PLC and frequency converter, servo drive system, industrial robot.
- Zero crossing products are used for AC voltage regulation.
- Household appliances and consumer electronics: Motor forward and reverse heating control, speed regulation, etc
- Used for dimming control in lighting systems.
- Power System and Energy Management: Used for rectification, transformer protection, and power grid monitoring, Applied to uninterruptible power supply (UPS) and power protection equipment.
- Medical and Special Scenarios: Used for isolation and circuit protection of devices such as heart rate monitors and X-ray machines.



### Ordering Information

XL    30VX    (X)    ( X ) -    ( U )    ( N )    ( Y )  
 ①            ②            ③            ④                    ⑤            ⑥            ⑦

- ① Brand(XL)
- ② Product series ( V:3,4,6,8; X:0,1,2,3,4 )
- ③ Package type (DIP6: None, DIP6-M: M,SMD6: S)
- ④ Halogen option (None :Halogen free)
- ⑤ Lead frame (None: Copper)
- ⑥ Customer option 1 (0-9 or A-Z or none)
- ⑦ Customer option 2 (0-9 or A-Z or none)

Part Number	Package	Shipping Quantity	Marking Code
XL30V <sup>1</sup> X <sup>2</sup>	DIP6	65pcs / Tube	XL30V <sup>1</sup> X <sup>2</sup>
XL30V <sup>1</sup> X <sup>2</sup> M	DIP6-M	65pcs / Tube	XL30V <sup>1</sup> X <sup>2</sup>
XL30V <sup>1</sup> X <sup>2</sup> S	SMD6	1000pcs / Tape & Reel	XL30V <sup>1</sup> X <sup>2</sup>

### Marking Information

- " XL" denotes brand
- " V" denotes VDRM digit: 3, 4, 6,8
- " X" denotes IFT digit: 0, 1, 2, 3, 4
- " Y" denotes Year : A(2024), B(2025), C(2026)
- " WW" denotes Week' s number
- " N" denotes the day of Week

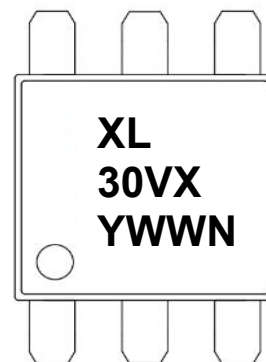

### XL303X, XL304X, XL306X, XL308X

#### Maximum Ratings (@ T<sub>A</sub> = 25°C unless otherwise specified)

Parameter		Symbol	Value	Unit	
Input	Forward Current	I <sub>F</sub>	60	mA	
	Reverse Voltage	V <sub>R</sub>	6	V	
	Power Dissipation	P <sub>D</sub>	100	mW	
	Derating factor (above T <sub>a</sub> = 85 °C)		3.8	mW/°C	
Output	Power Dissipation	P <sub>C</sub>	300	mW	
	Derating factor (above T <sub>a</sub> = 85 °C)		7.6	mW/°C	
	Off-state Output Terminal Voltage	XL303X	V <sub>DRM</sub>	250	V
		XL304X		400	
		XL306X		600	
		XL308X		800	
	Peak repetitive surge current (pw=100μs, 120pps)	I <sub>TSM</sub>	1	A	
Turn-on current (root mean square value)	I <sub>T(RMS)</sub>	100	mA		

#### Thermal Characteristics

Parameter	Symbol	Value	Unit
Total Power Dissipation	P <sub>TOT</sub>	350	mW
Isolation Voltage *2	V <sub>ISO</sub>	5000	V <sub>rms</sub>
Operating Temperature	T <sub>OPR</sub>	-55 ~ +100	°C
Storage Temperature Range	T <sub>STG</sub>	-55 ~ +125	°C
Soldering Temperature *3	T <sub>SOL</sub>	260	°C

#### Notes:

1. Pulse width ≤ 1μs, Duty ratio: 0.001
2. 40 to 60% RH, AC for 1 minute. At this time, pins 1, 2 & 3 are shorted, and pins 4, 5 & 6 are shorted together.
3. For 10 seconds

### XL303X, XL304X, XL306X, XL308X

#### Electrical Characteristics (@ T<sub>A</sub> = 25°C unless otherwise specified)

Parameter		Symbol	Test Condition	Min.	Typ.	Max.	Unit	
Input	Forward Voltage	V <sub>F</sub>	I <sub>F</sub> =20mA	-	1.2	1.4	V	
	Reverse Leakage current	I <sub>R</sub>	V <sub>R</sub> =6V	-	-	10	μA	
Output	Peak Blocking Current	XL303X	I <sub>DRM</sub> V <sub>DRM</sub> =Rated V <sub>DRM</sub> , I <sub>F</sub> = 0mA	-	-	100	nA	
		XL304X						
		XL306X						
		XL308X						
	Peak on-state voltage		V <sub>TM</sub>	I <sub>TM</sub> =100mA, I <sub>F</sub> =Rated I <sub>FT</sub>	-	-	3	V
	Critical Rate of Rise off-state Voltage	XL303X	dv/dt	V <sub>PEAK</sub> =Rated V <sub>DRM</sub> , I <sub>F</sub> = 0mA	1000	-	-	V/μs
		XL304X						
XL306X								
XL308X								
Inhibition voltage (MT1-MT2 voltage above which device will not trigger)		V <sub>Inh</sub>	I <sub>F</sub> = Rated I <sub>FT</sub>			20	V	
Leakage in Inhibited State		I <sub>DRM2</sub>	I <sub>F</sub> = Rated I <sub>FT</sub> V <sub>DRM</sub> =Rated V <sub>DRM</sub> off state			500	μA	
Transfer Characteristics	LED trigger current	XL3031	I <sub>FT</sub>	Main terminal voltage = 3V	-	-	mA	
		XL3041						
		XL3061						
		XL3081						
		XL3032						
		XL3042						
		XL3062						
		XL3082						
		XL3033						
		XL3043						
		XL3063						
		XL3083						
		XL3034						
		XL3044						
	XL3064							
XL3084								
Holding Current		I <sub>H</sub>		-	250		μA	

#### Ratings and Characteristics Curves (@ $T_A = 25^\circ\text{C}$ unless otherwise specified)

Fig.1 LED Positive voltage vs Positive current

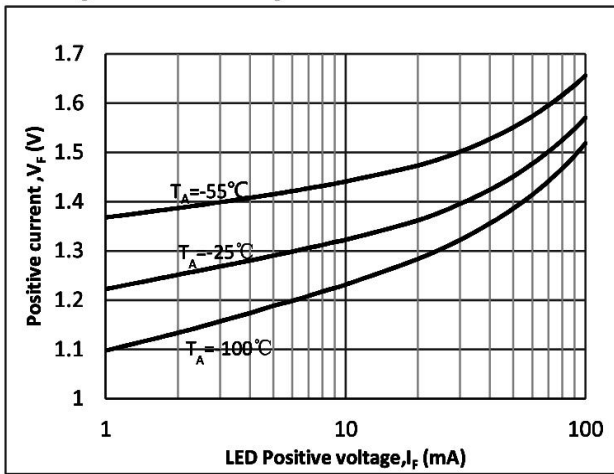

Fig.2 On-state characteristic

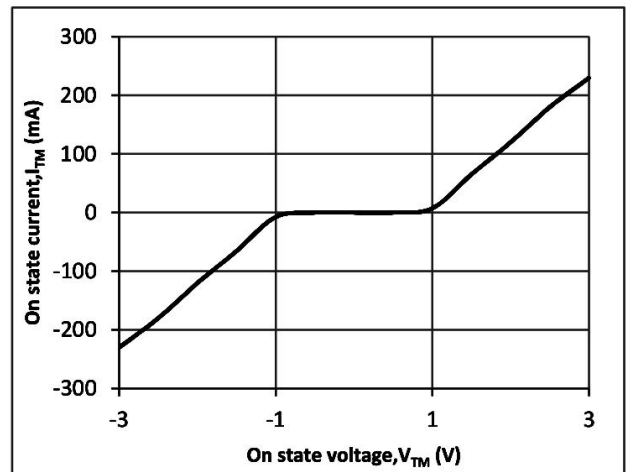

Fig.3 Trigger current vs Ambient temperature

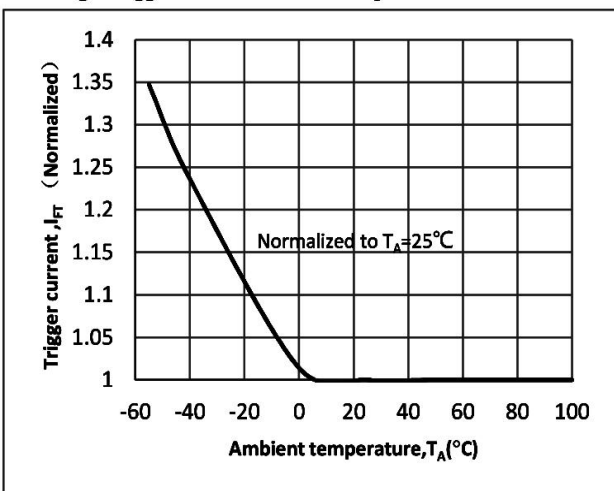

Fig.4 LED Trigger current vs LED Pulse Width

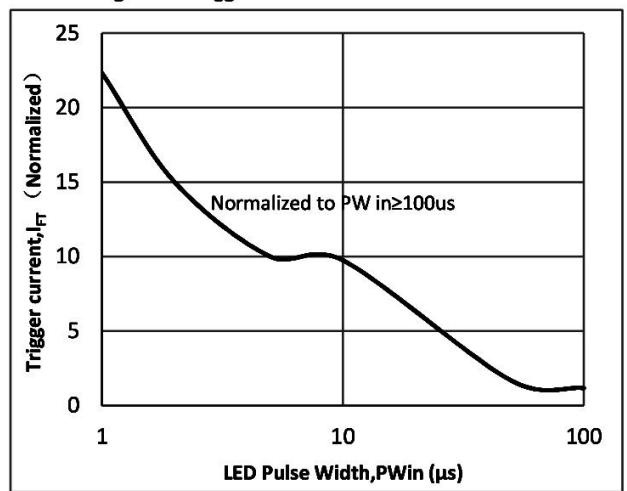

Fig.5 Holding current vs Temperature

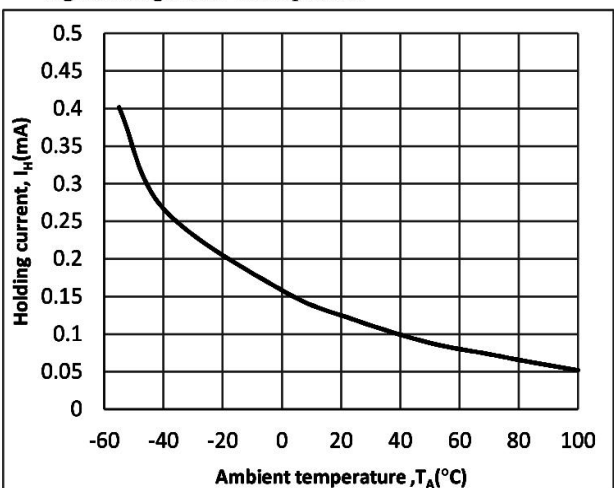
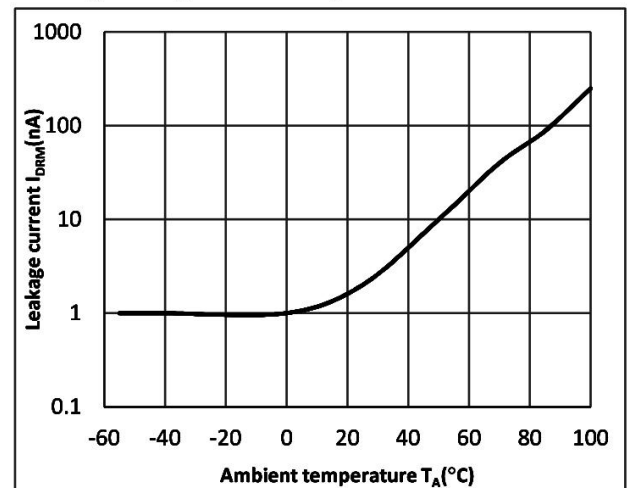

Fig.6 Leakage current vs Temperature



#### Ratings and Characteristics Curves (@ T<sub>A</sub> = 25°C unless otherwise specified)

Fig.7 Inhibit state leakage current vs Ambient temperature

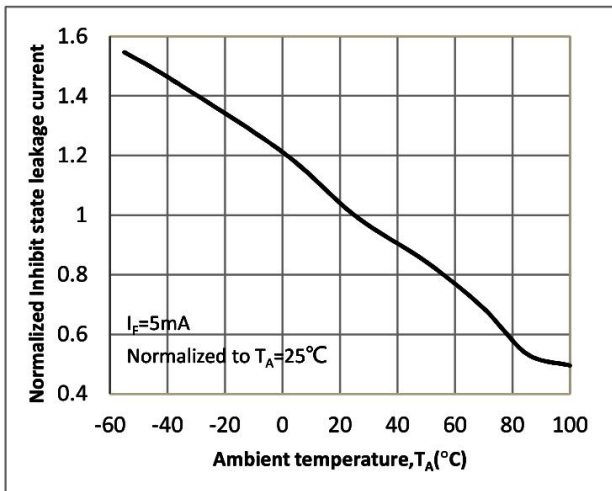

Fig.8 Inhibition voltage vs Ambient temperature

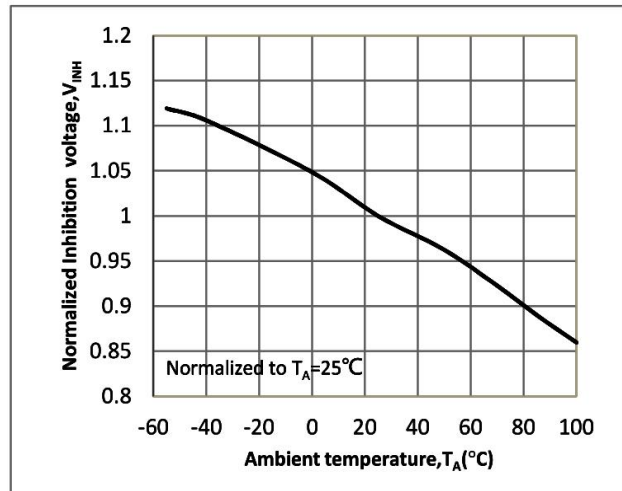
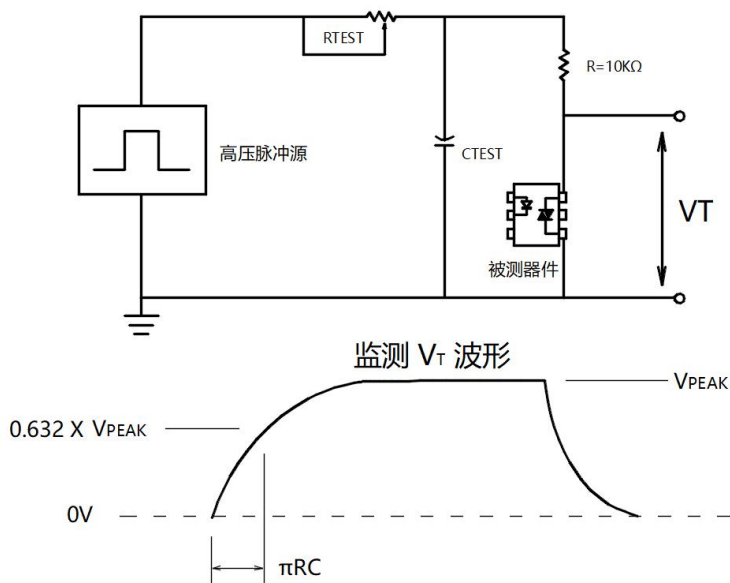

Fig.9 Static dv/dt test circuit and waveform



The high voltage pulse applied to the output of the device under test through the RC circuit is set to the required V<sub>PEAK</sub> value. LED current is not applied. The waveform V<sub>T</sub> is monitored with X100 probe. By adjusting the R<sub>TEST</sub> value, the dv/dt (slope) increases until the device under test is observed to be triggered (waveform collapse). Then dv/dt drops until the device under test stops being triggered. At this point, RC is recorded and the dv/dt calculated.

$$dv/dt = \frac{0.632 \times V_{PEAK}}{\tau_{RC}}$$

For example, V<sub>PEAK</sub> = 400V for BL52X series. The dv/dt value is calculated as follows:

$$dv/dt = \frac{0.632 \times 400}{\tau_{RC}} = \frac{252}{\tau_{RC}}$$

#### Package Outline Dimensions (unit: mm)

##### DIP6

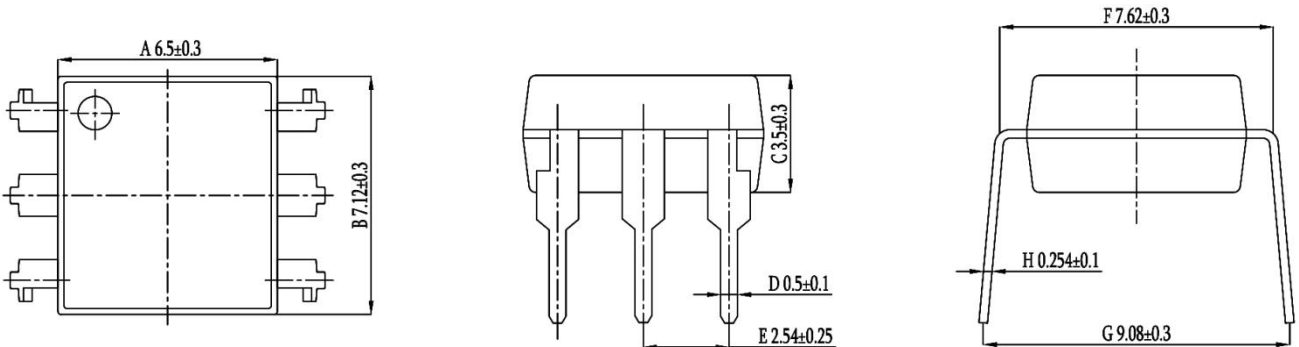

##### DIP6-M

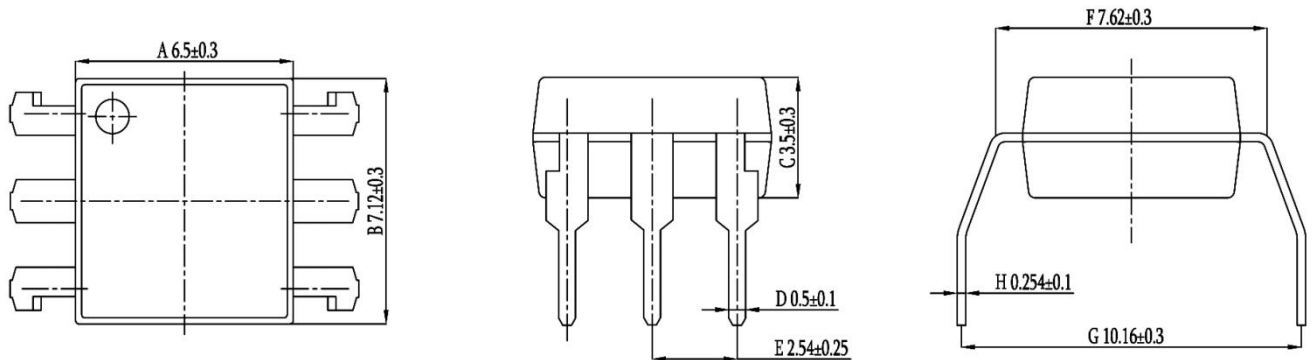

##### SMD6

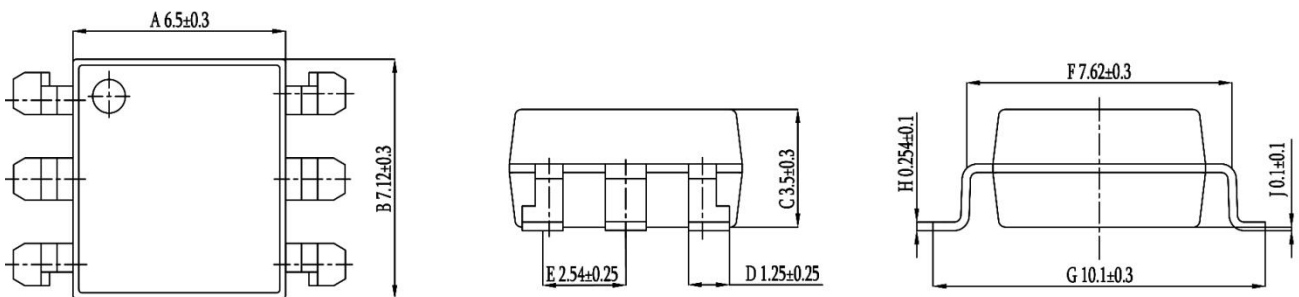

#### SOLDERING FOOTPRINT (unit: mm)

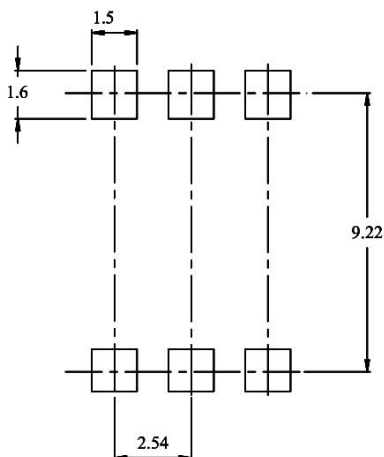

### Reflow soldering

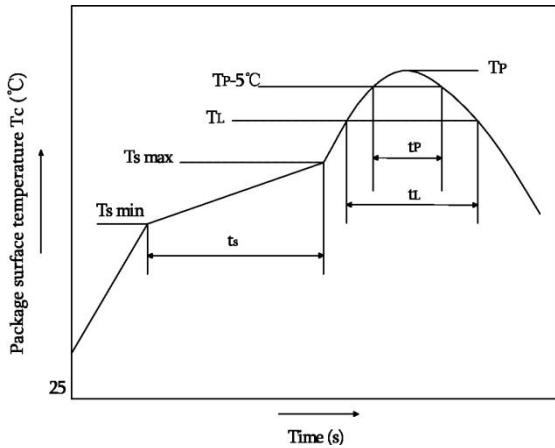

	Symbol	Min	Max	Unit
Preheat temperature	Ts	150	200	°C
Preheat time	ts	60	120	s
Ramp-up rate(Tl to Tp)	-	-	3	°C/s
Liquidus temperature	Tl	217		°C
Time above Tl	tL	60	150	s
Peak temperature	Tp	260		°C
Time during which Tc is between (Tp-5) and Tp	tp	-	30	s
Ramp-down rate(Tp to Tl)	-	-	6	°C/s

#### Note:

Reflow soldering is recommended at the temperatures and times shown, no more than three times.

### Wave soldering

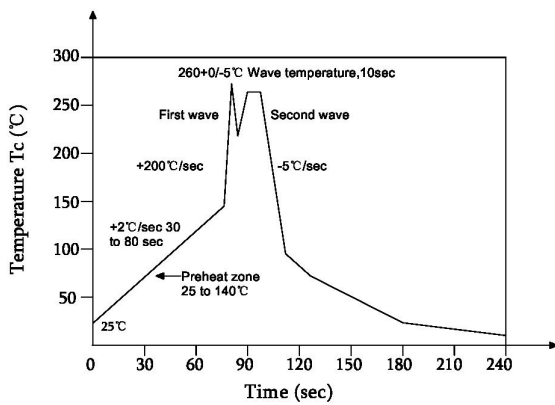

Profile feature	
Average ramp-up rate	~200°C/s
Heating rate during preheat	1°C/s to 2°C/s typical; 4°C/s maximum
Final preheat temperature Ts	~130°C
Preheat time (25°C to Ts)	> 60s
Peak temperature Tp	260°C
Time within peak temperature tp	10s
Ramp-down rate	5°C/s maximum

#### Soldering with hand soldering iron

- Hand soldering iron is only used for product rework or sample testing.
- Hand soldering iron requirements: Temperature: 360 °C ± 5°C within 3s.

### Packing

Package Type	Packing Form	Quantity per Tube & Reel	Quantity per Box	Quantity per Carton	Antistatic Bag Specification	Box Specification	Carton Specification	Note
DIP6	Tube(500mm)	65 pcs/tube	50 tubes /box	10 boxes /ctn	190*670mm	520*105*50mm	545*372*235mm	Straight insert type material tube
DIP6-M	Tube(500mm)	65 pcs/tube	50 tubes /box	10 boxes /ctn	190*670mm	520*105*50mm	545*372*235mm	Seagull foot (M foot) tube
SMD6	Reel(φ330mm)	1000 pcs/reel	2 reels /box	10 boxes /ctn	380*420mm	350*340*60mm	365*330*370mm	Guard band 200mm /min.

#### ■ Summary table

#### ■ DIP6/DIP6-M (Tube)

Qty/ tube: 65pcs. Qty/box: 3250pcs.

Qty/ctn: 32500pcs.

Schematic: (unit:mm)

#### ■ SMD6 (Reel)

Qty/reel: 1000pcs. Qty/box: 2000pcs.

Qty/ctn: 20000pcs.

Schematic: (unit:mm)

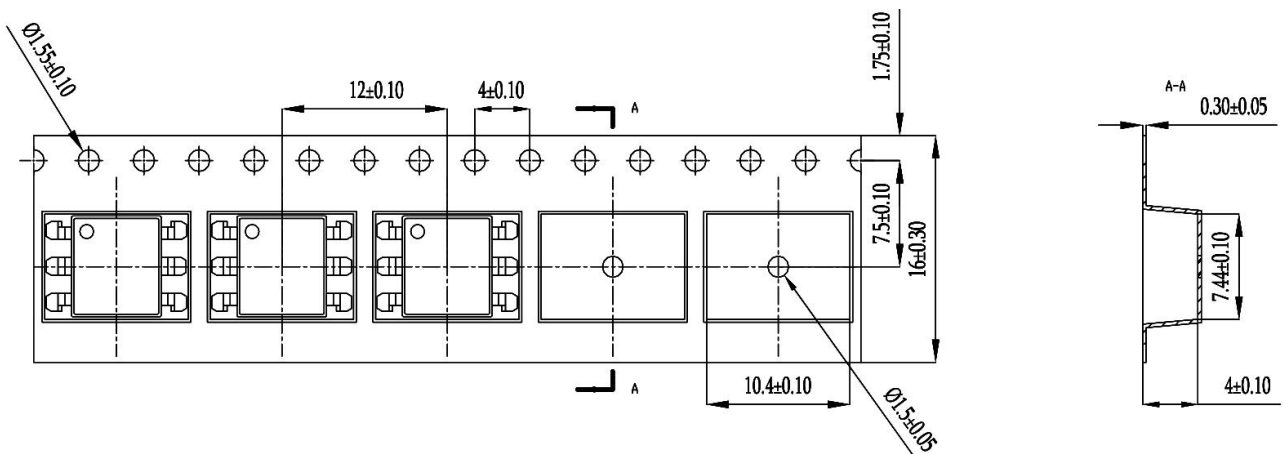

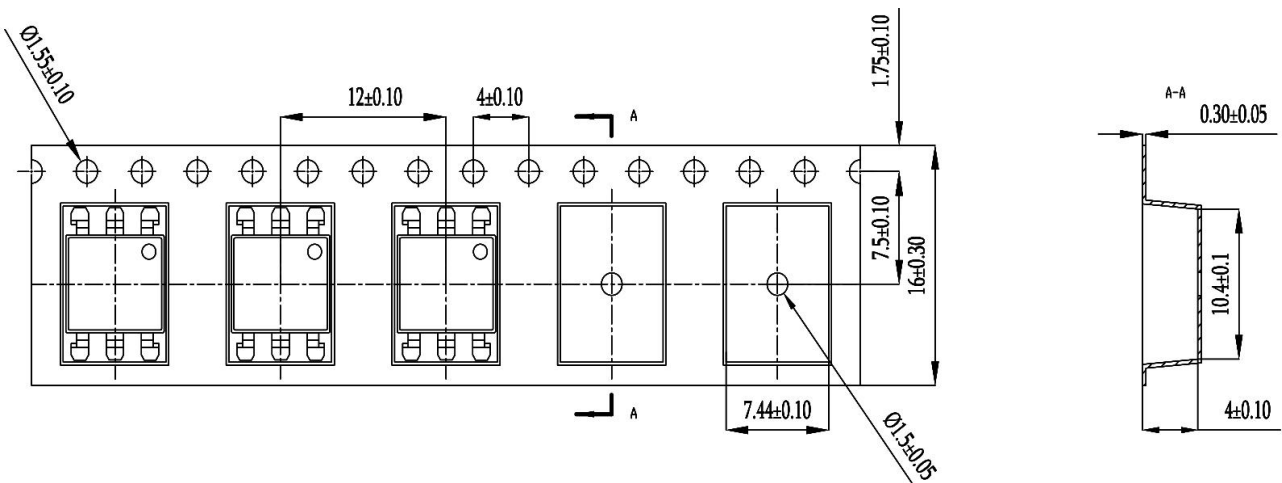

**Attention**

- XINGLIGHT implements dynamic technical updates. Specifications are subject to change. Refer to the official website for the latest version.
- Users must strictly adhere to specified conditions. Failures caused by misuse (overload, high temperature, incompatible circuits) are excluded from warranty.
- Contact technical support for customized validation in critical applications (medical devices, industrial control).
- This document is valid until Dec 31, 2026. Updates will be notified on the official website.
- For further clarification on technical specifications or application solutions, please contact us through official channels.